

Helix

Dalton Pearson
Emily Webster
Ian Quarterman
Lauren Afendis
Steven Polchinski

Need for Proposal

MINNETRISTA IS A place for gathering, the home of the Ball Jar, and your community center. People all over the region donate to Minnetrista and there is a need for recognition for those who have given to the community. A donor wall that celebrates the history and the people of Muncie combined with the beautiful qualities of glass is a wonderful way to show appreciation for those who donate. *Helix* combines glass with the deep history of Muncie and the Ball family to merge into a cohesive, a commemorative recognition of the groups and individuals who have donated. Emulating inspiration from The Ball Jar, we are representing the annual donors and others, by assigning a historical color of the ball jar to represent the different levels. The colors are amber, green, teal and purple, which flow through the composition.

Using techniques in glass casting, our individual donor tiles are each unique and different, much like the colors of certain ball jars made with swirling colors. Not only is glass relevant historically to this site, it is also a strong and luxurious material, that will withstand the tests of nature and time. Glass combined with steel structuring, makes *Helix* a long lasting and sturdy installation that also allows for continual growth as more people donate. Each donor has their name cut into a uniquely colored glass tile with a water jet cutter, creating precise and delicate lettering to compliment the glass.

Located outside *Catalyst* and the center building, the selected site of this installation takes advantage of popular foot traffic to highlight donors to all who pass, potentially encouraging others to donate and see their name in glass. This specific location also will also utilize the natural light of the sun to illuminate the transparent glass and cast beautiful, colorized shadowing onto surrounding surfaces.

Our Inspiration

OUR EXPLORATION began with discussing our vision for the wall. We knew right away that we would include the Ball Jar colors to relate the wall back to Minnetrista. We started with blue and yellow because to test their transparency when facing the sun. After we explored the reflection of the samples through a darker blue tile, we included the colors green and purple, to make more test samples that could create that reflection through the use to two tiles in one spot. Multiple discussions and searches of wall and tile dimensions lead us to the Oakland Museum of California Donor Wall. The wall did not have a particular shape and had slits in every other space so that more names could be placed into those spots as well as more slit lines.



Courtesy of Minnetrista Heritage Collection, Muncie, Indiana.

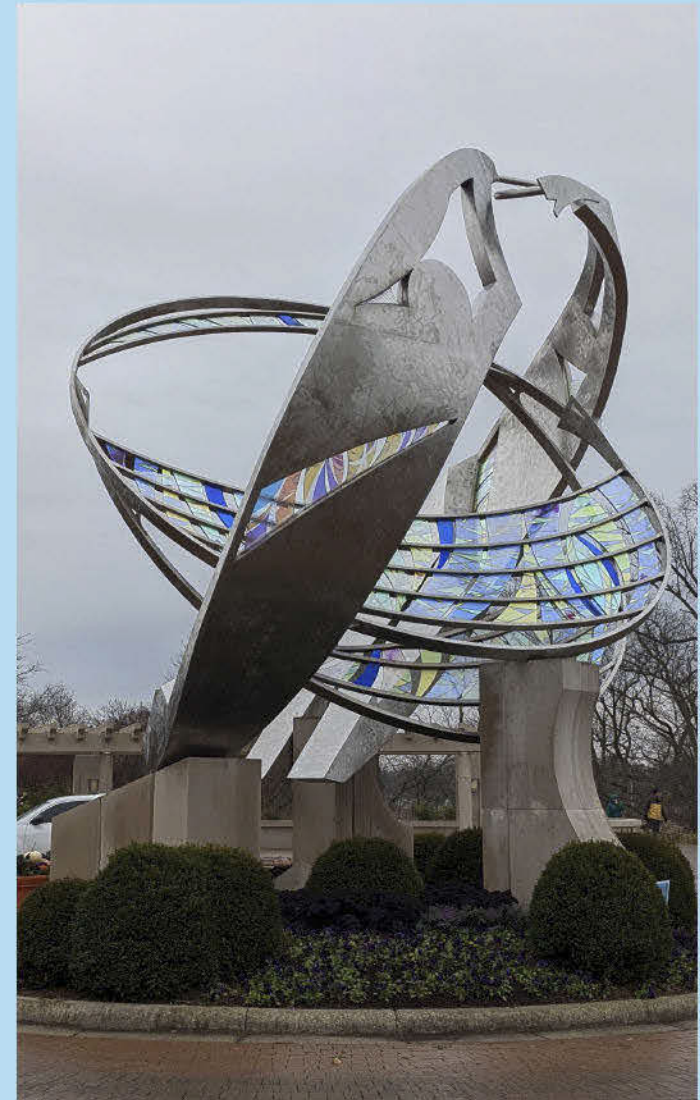

Initial Sketches

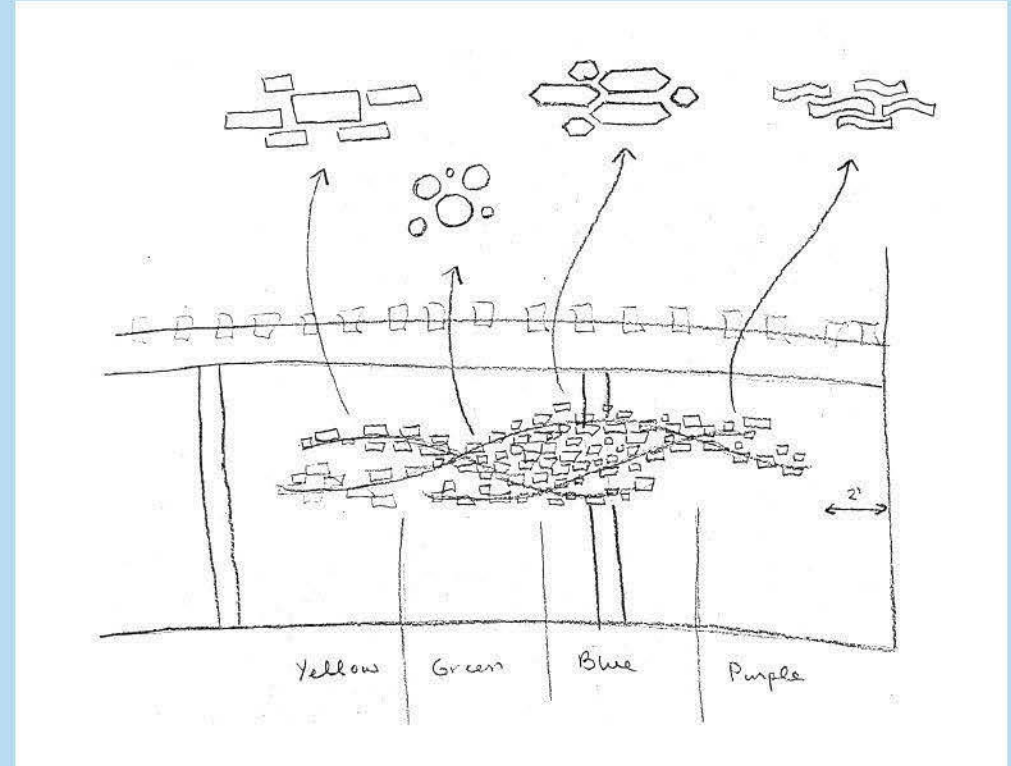
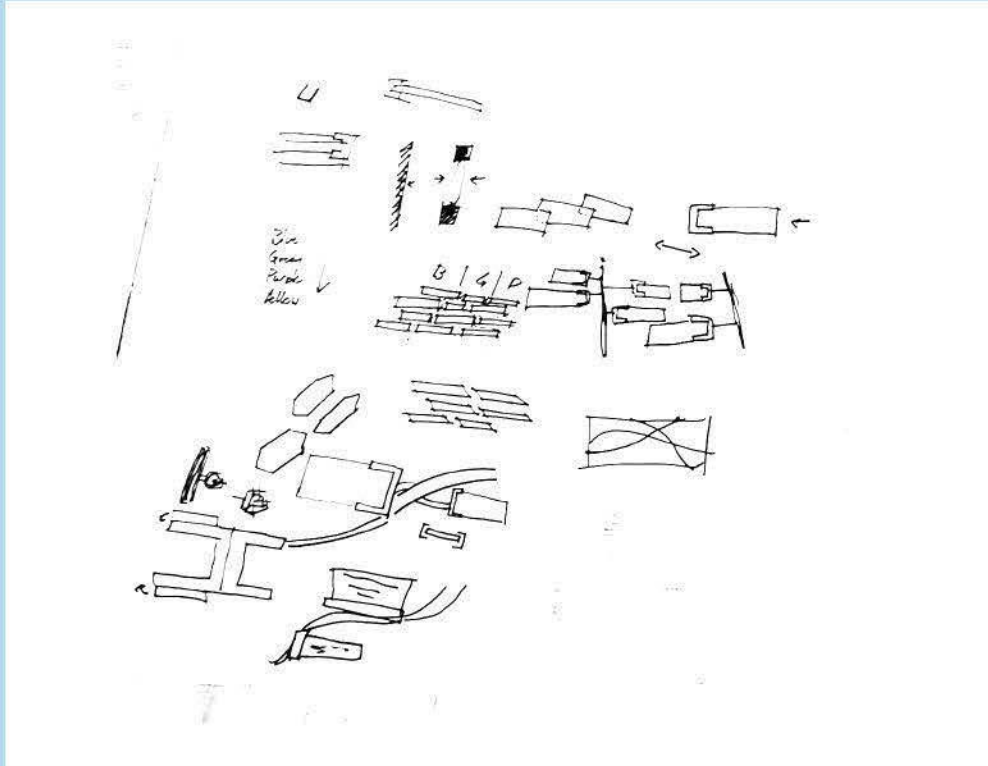

Test Samples

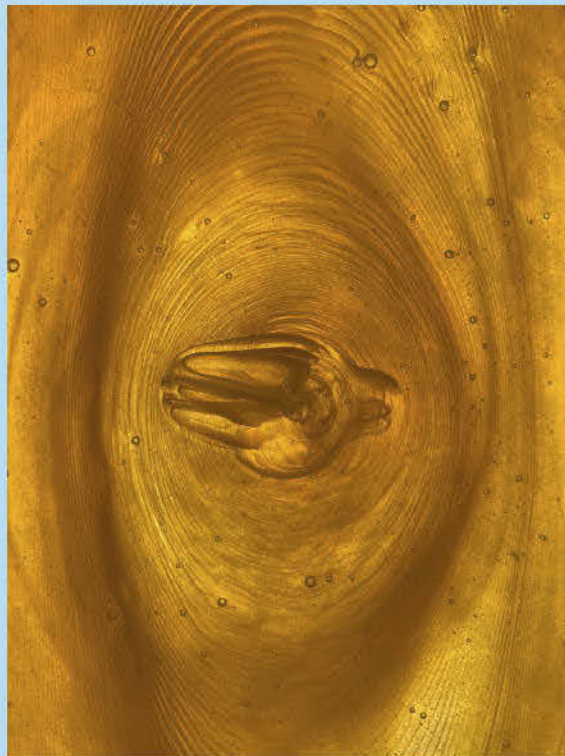
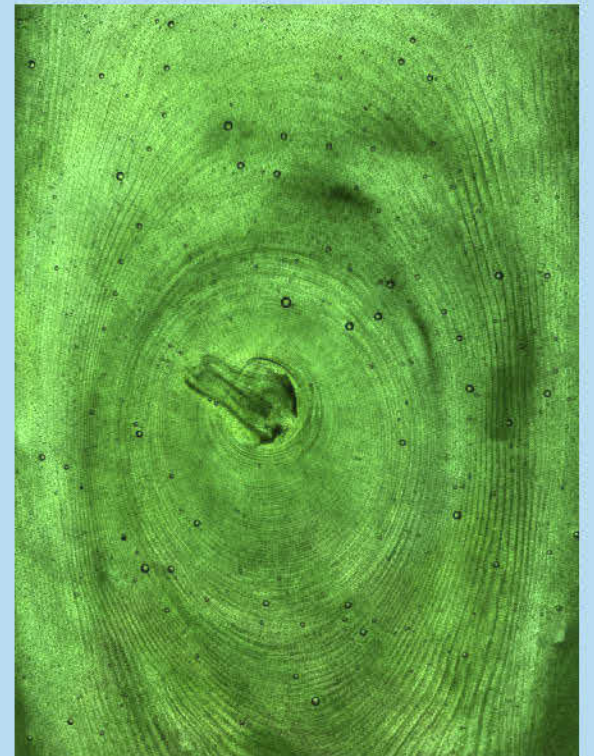
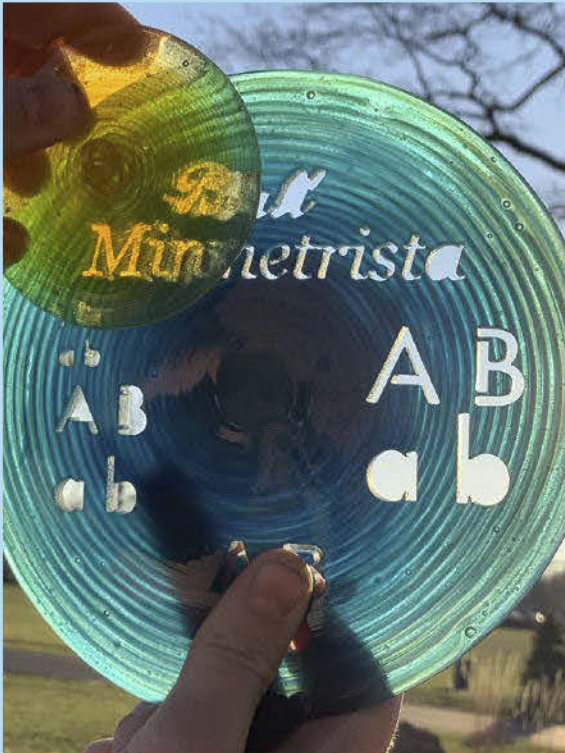

Prototypes



Our Proposal

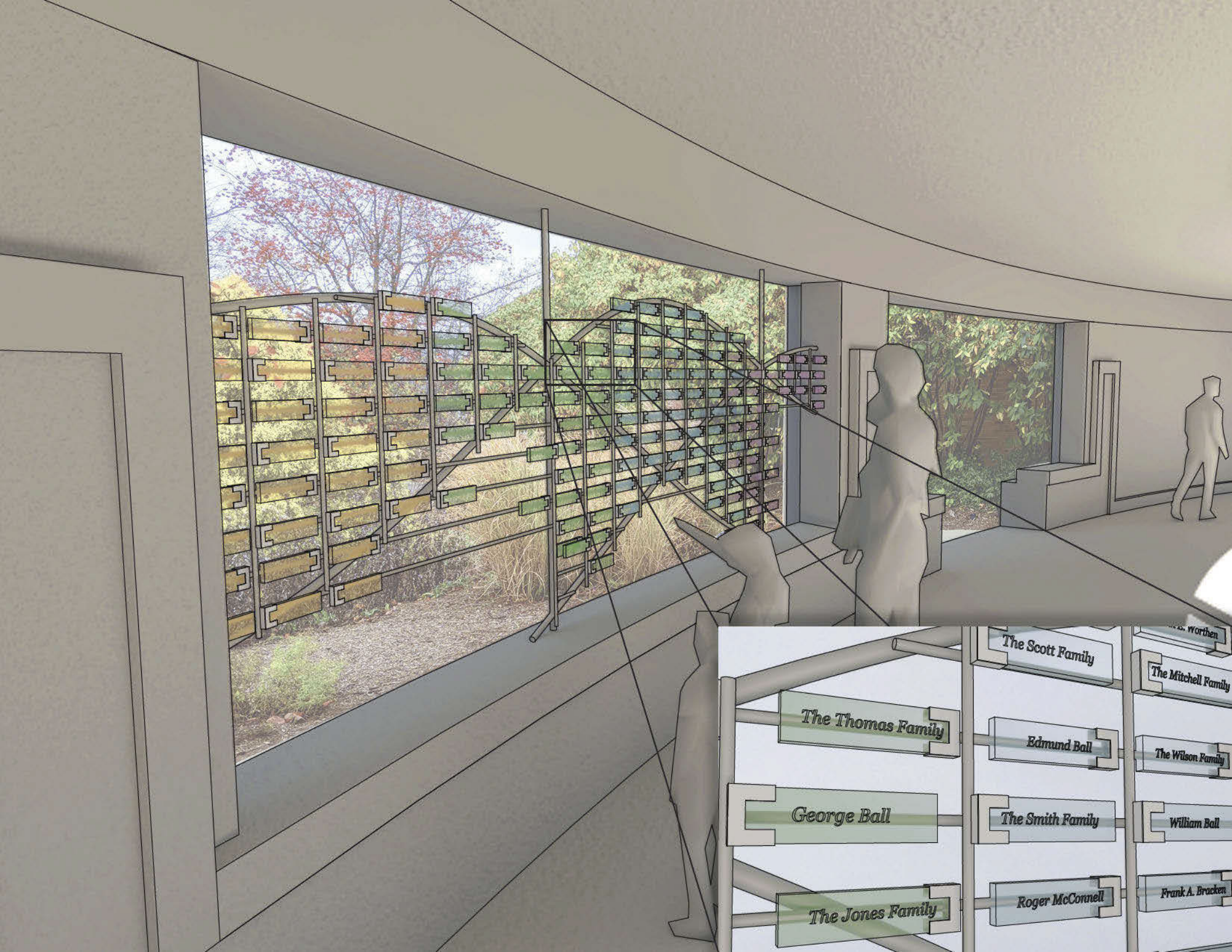

	The Scott Family	...s. Worthen
The Thomas Family	Edmund Ball	The Mitchell Family
George Ball	The Smith Family	The Wilson Family
The Jones Family	Roger McConnell	William Ball
		Frank A. Bracken

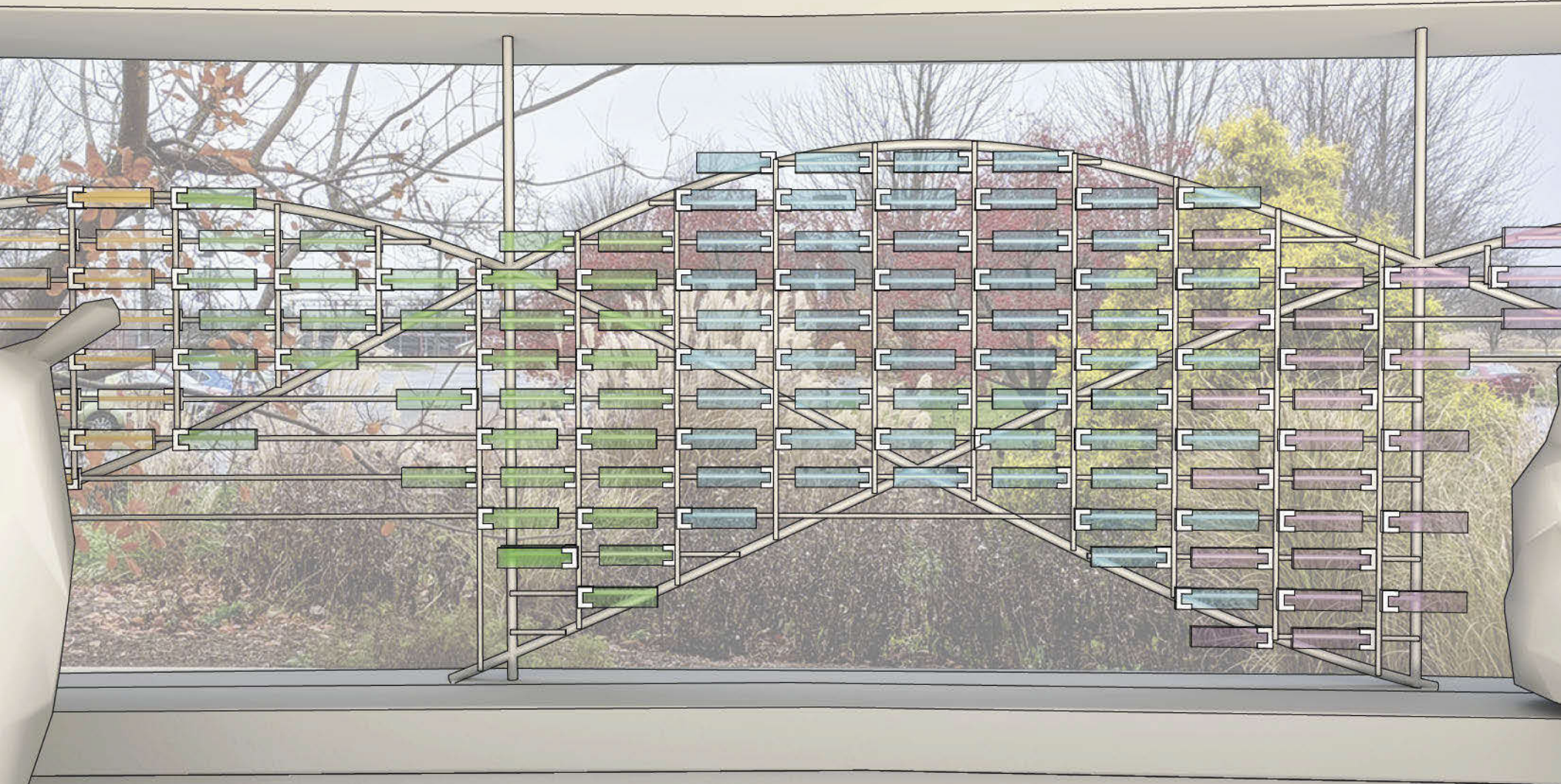

THE STRUCTURE consists of a welded steel framework and bracket system to mount the glass tiles. The brackets are fabricated to fit firmly onto the glass tile, and the tile is adhered with epoxy that will allow that materials to expand and contract freely. The steel framework features a sweeping super-structure with a gridded sub-structure. The brackets include a mounting ring that can be attached to the sub-structure elements. This system allows more tiles to be added over time and accounts for adjustments that may occur as more tiles are added.

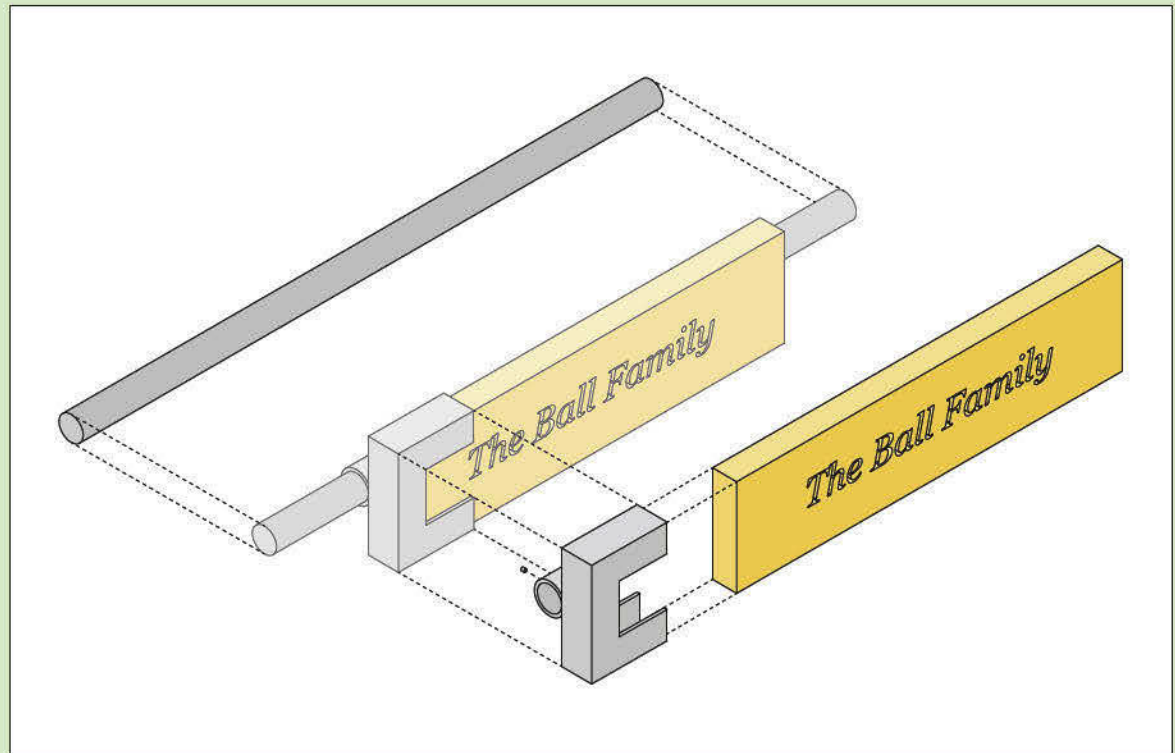
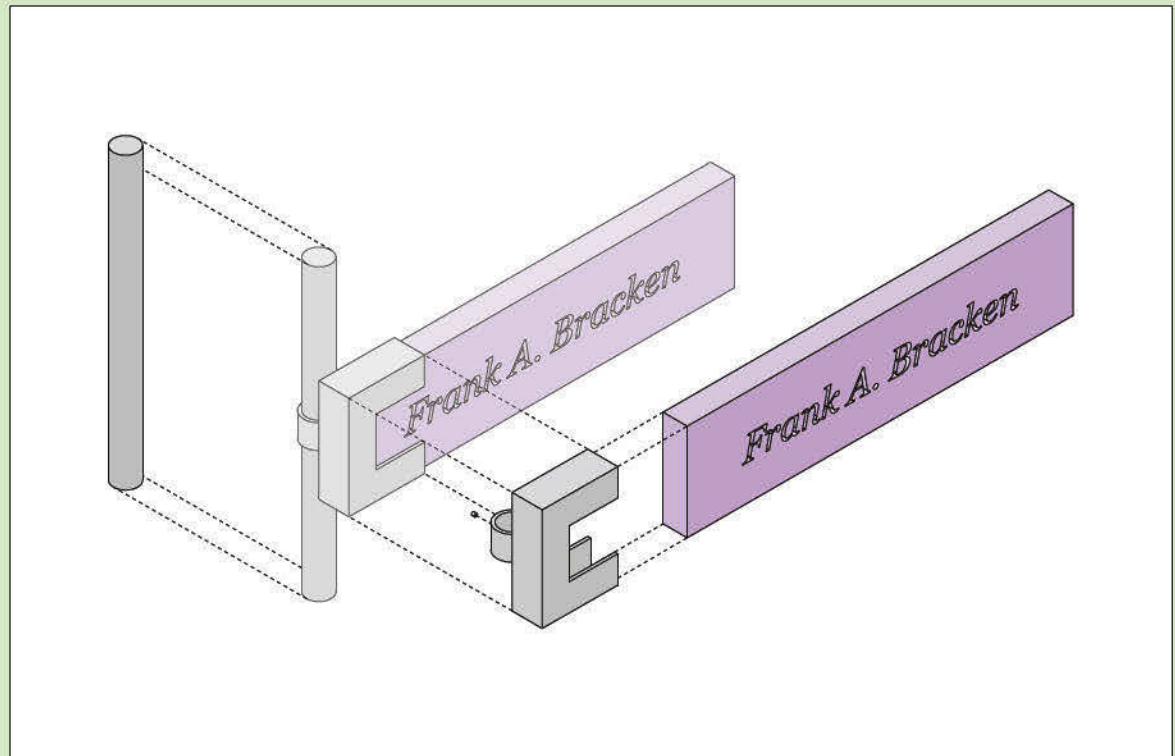

Sections & Elevations

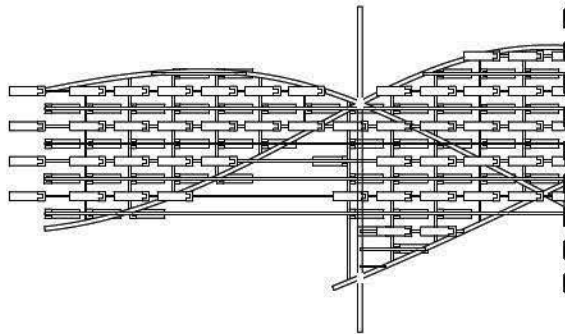
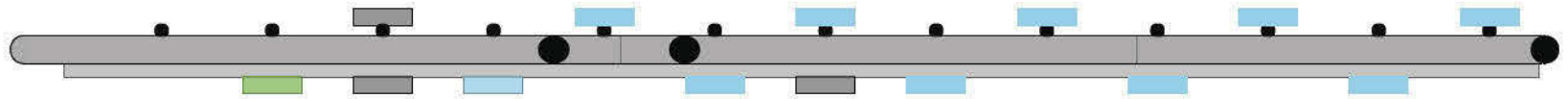
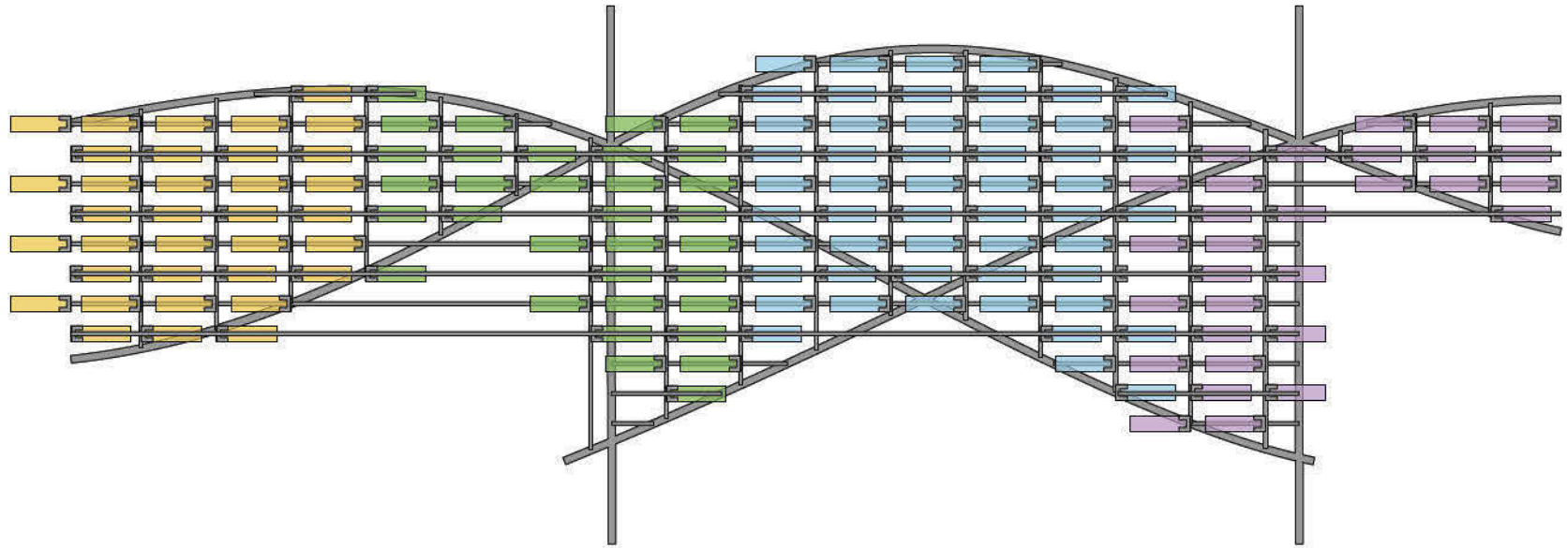

Final Thoughts

HELIX REPRESENTS the most important people to Minnetrista, those that make every new endeavor possible, the donors. Without them, all of the great opportunities and programs would not be feasible. *Helix* honors their contributions and acknowledges the people that make Minnetrista unique, exciting, and inclusive. The connections to *Catalyst*, the centerpiece of the site, are present in the steel and glass structure, as well as the shifting colors of each of the glass tiles. Additionally, *Helix* represents the history of the Ball Jar by referencing the unique colors created by the swirled glass. With this installation, donors will receive a one-of-a-kind tile to represent their contribution and dedication to Minnetrista. The interplay of light and color in the installation will capture attention and create a dynamic point of interaction between Minnetrista's users and those that make everything possible.

Family

The Thomas Family

George Ball

The Jones Family

Williams Family

Marilyn K. Glick

The Scott Family

Edmund Ball

The Smith Family

Roger McConnell

Lucius Ball

John E. Worthen

The Mitchell Family

The Wilson Family

William Ball

Frank A. Brack

David Letterman

Bob Ross